

H
G
F
E
D
C
B
A

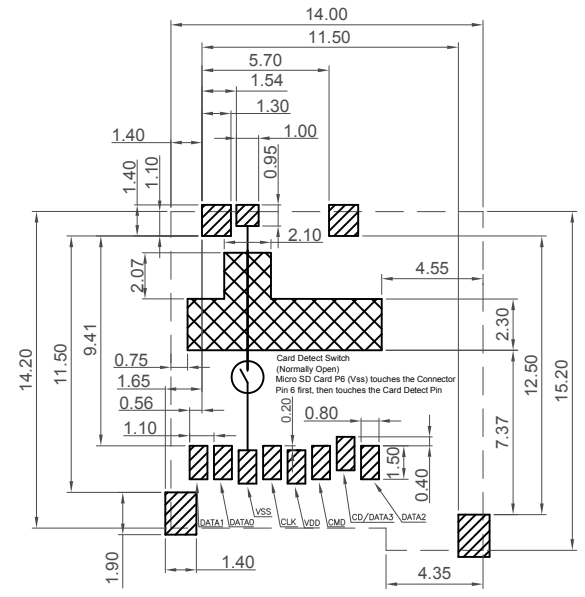

Recommended PCB Layout
As viewed from component side General Tolerance: ±0.05

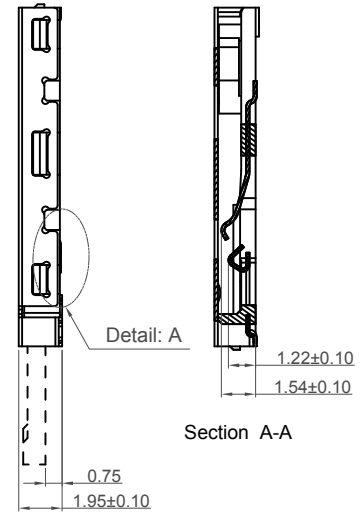
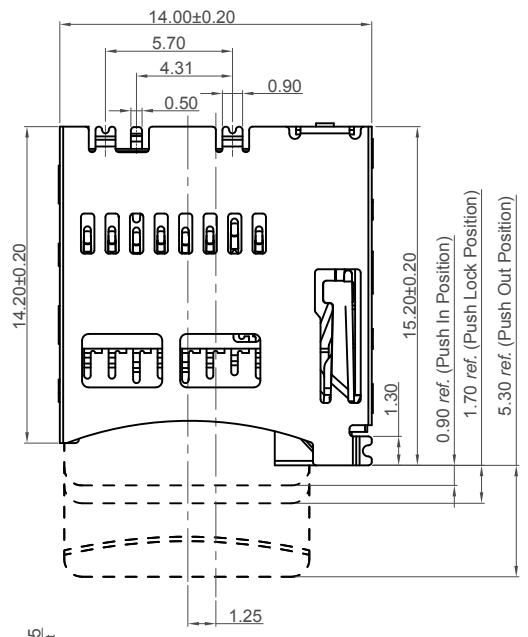
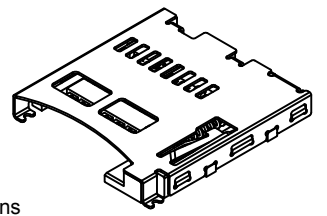

Specifications

- Material
- Plastic Housing: Hi-temp Thermoplastic, UL94V-0, Black
- Contact Terminal: Copper Alloy
- Metallic Shell: Stainless Steel
- Coil Spring: SWP
- Latch: Stainless Steel
- Slider: Hi-temp Thermoplastic, UL94V-0, Black
- Card Detect Pin: Copper Alloy

- Plating**
- Contact Terminal: Under-plating: 50µ" min. Nickel all over; Contact Area: Gold Flash; Soldering Area: 80µ" min. Matte Tin
 - Metallic Shell: Under-plating: 50µ" Nickel all over; Soldering Area: Gold Flash
 - Card Detect Pin: Under-plating: 50µ" min. Nickel all over; Contact Area: Gold Flash; Solder Tail: Gold Flash

- Electrical**
- Voltage Rating: 100 V AC max
 - Current Rating: 0.5 A max.
 - Contact Resistance: 100mΩ max.
 - Insulating Resistance: 1000MΩ min.
 - Dielectric Withstand Voltage: 500 V AC

- Mechanical & Environmental**
- Durability: 5000 Cycles
 - Operating Temperature: -40°C to +85°C

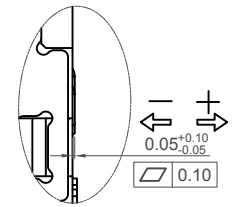
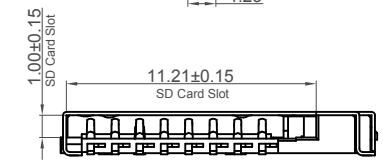

Detail A Scale 2:1

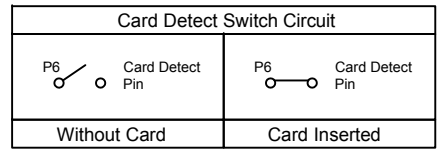

MICRO SD CARD PIN OUT

Pin	Name	Description
P1	DAT2	Data Bit 2
P2	CD/DAT3	Card Detect/Data Bit 3
P3	CMD	Command Line
P4	V _{DD}	Supply Voltage 2.7V/3.6V
P5	CLK	Clock
P6	V _{SS}	Ground
P7	DAT0	Data Bit 0
P8	DAT1	Data Bit 1

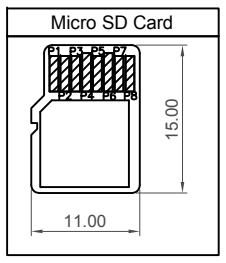

Ordering Grid

MEM2051 - 00 - 195 - 00 - A

Switch: 00 = Normally Open Locating Post: 00 = Without Packing Options: A = Tape & Reel (1000 per Reel)

[Request Samples and Quotation](#)

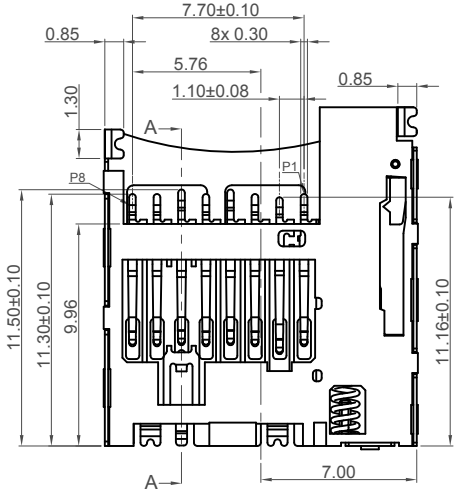

Part Number MEM2051		Product Description Micro SD Memory Card Connector			This drawing is confidential and copyright of Global Connector Technology, Ltd (GCT). This drawing must not be copied or disclosed without written consent. E & OE		www.gct.co
Drawing Date 2nd November 2011		Push-Push, SMT, Card Entry Normal, 1.95mm Profile					
By	CC	Tolerances (Except as Noted)	Units:				Not to Scale
Detail	MEM2051	Length D PCN	Metric (mm)				
Revision	D1	X.X ±0.35 X.XX ±0.25 X.XXX ±0.150	Angle X° ±1° X.X° ±0.5° X.XX° ±0.25°				Drawn By ASE
Date	21/02/19						Sheet No. 1/2

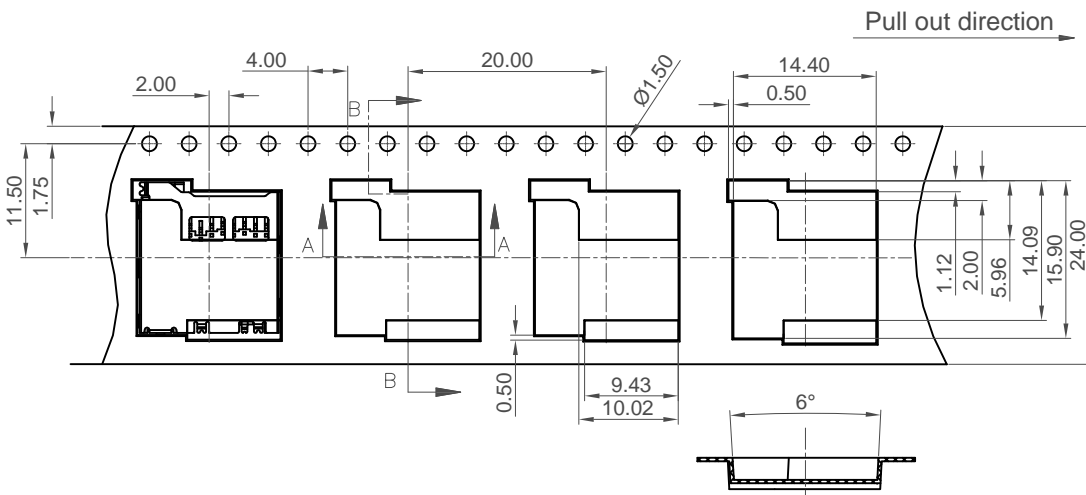

Section A-A

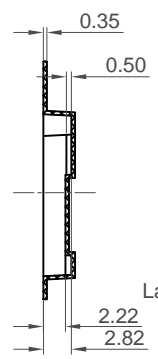

Section B-B

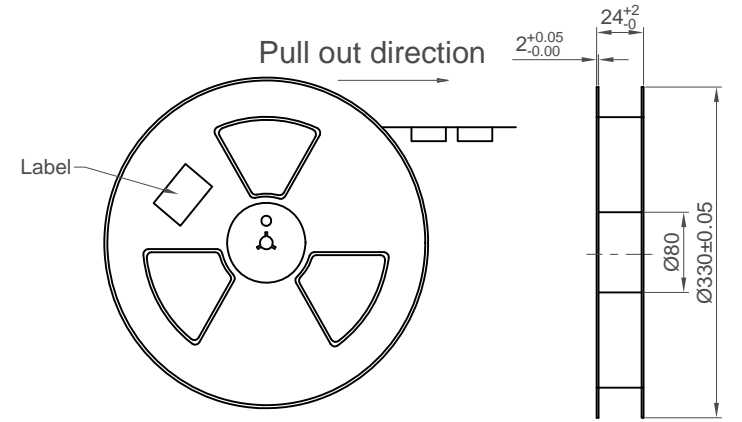
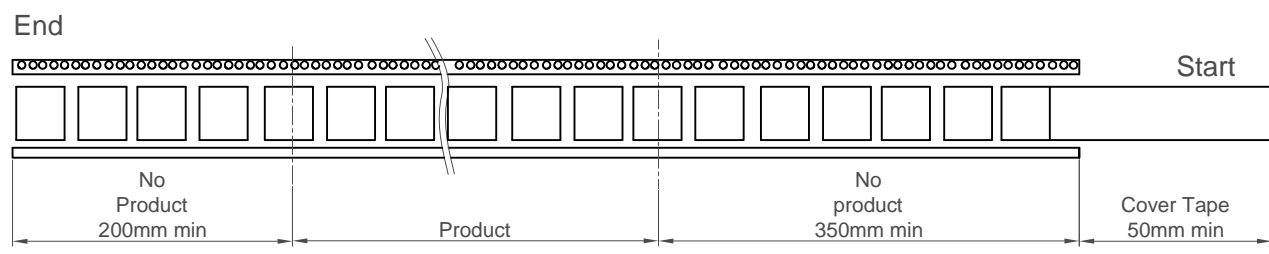
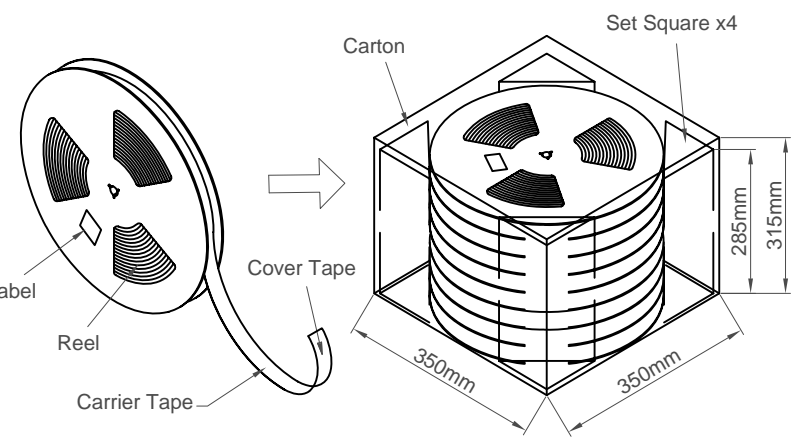

Gross Weight - Reel:0.86 KG
Quantity:1000 pcs/Reel

Notes:

- 1.Primary Packing: 1,000 pcs/reel
- 2.Secondary Packing: 10 reel/carton (10k pieces/carton)
- 3.Gross Weight:9.43Kg/carton

Part Number		Product Description			This drawing is confidential and copyright of Global Connector Technology, Ltd (GCT). This drawing must not be copied or disclosed without written consent. E & OE
MEM2051		Micro SD Memory Card Connector			
Drawing Date		Push-Push, SMT, Card Entry Normal, 1.95mm Profile			
2nd November 2011					
By	CC	Tolerances (Except as Noted)	Units:		
Detail	MEM2051 D PCN	Length	Metric (mm)		
Revision	D1	Angle			
Date	21/02/19				
Not to Scale		Drawn By ASE		Sheet No. 2/2	

